

Platinum
SERIES

**Frankford
Arsenal** 
Reloading Tools

ROTARY TUMBLER

Product #909544

Instructions #1026186

Care & Usage Instructions

SPECS: 120v~60Hz. 1.3A

Contents:

- 1 - tumbler drum**
- 1 - motorized roller base**
- 2 - end caps**
- 2 - sealing inserts**
- 2 - rubber seals**
- 2 - sifting inserts**
- 1 - 5lbs. Stainless Steel Media**



STOP!

If you have a problem with this product, **DON'T RETURN IT TO THE STORE WHERE YOU PURCHASED IT.** Contact customer service at...

Battenfeld
Technologies, Inc.

2501 LeMone Industrial Blvd. / Columbia, MO 65201
573-445-9200 / Email: sales@battenfeldtechnologies.com
Or visit our website @ www.BTIbrands.com

NOT WARRANTED AGAINST MISUSE, ABUSE, OR COMMERCIAL USE.

Limited Warranty

Every Frankford Arsenal product is warranted to be free of defects in materials and workmanship for a period of one (1) year from the date of original purchase. Frankford Arsenal will, at its option, repair or replace without charge, except for transportation costs, parts that fail under normal use and service when operated and maintained in accordance with our Instructions. This warranty does not apply to normal wear or to items whose life is dependent upon their use and care. This warranty is in lieu of all other warranties, expressed or implied and releases Frankford Arsenal, its affiliates, and its vendors from all other obligations and liabilities.



WARNING: IMPORTANT SAFETY INFORMATION!

- Always practice safe firearm handling
- Always hold the forend of the firearm when shooting off of this shooting rest or any rest. If it is not held, the recoil can cause the forend to jump out of the front bag, possibly causing damage to the firearm or injuring the shooter.

Recommended Brass Cleaning Procedure for Reloading:

1. Before brass is deprimed (still has used primers seated) run the batch of brass through the tumbler for an initial cleaning. No need to use stainless steel pins in this step, as you are not concerned about cleaning the primer pockets in this step.
 - a. The purpose of this step is to clean the brass so that the brass is clean for handling operations. (De-priming, sizing, trimming, deburring)
 - b. Clean brass processing extends the life of sizing dies and other reloading equipment, and also is easier to handle throughout the reloading process.
2. After brass has been deprimed, sized, trimmed to length, and deburred, the brass is ready for its second cleaning.
 - a. Note that this second cleaning is very useful for removing case lube from case sizing.
 - b. For getting the inside of the case and primer pockets extra clean, add the provided 5lbs. Stainless Steel media to the batch of brass as outlined in the Tumbler Operation Instructions.

Tumbler Operation Instructions:

1. Install Seal and Sealing Insert into one end of the drum, and tighten the cap to seal off one end of the drum.
 - a. Seal and sealing surface must be clean and free of any debris to ensure a proper seal.

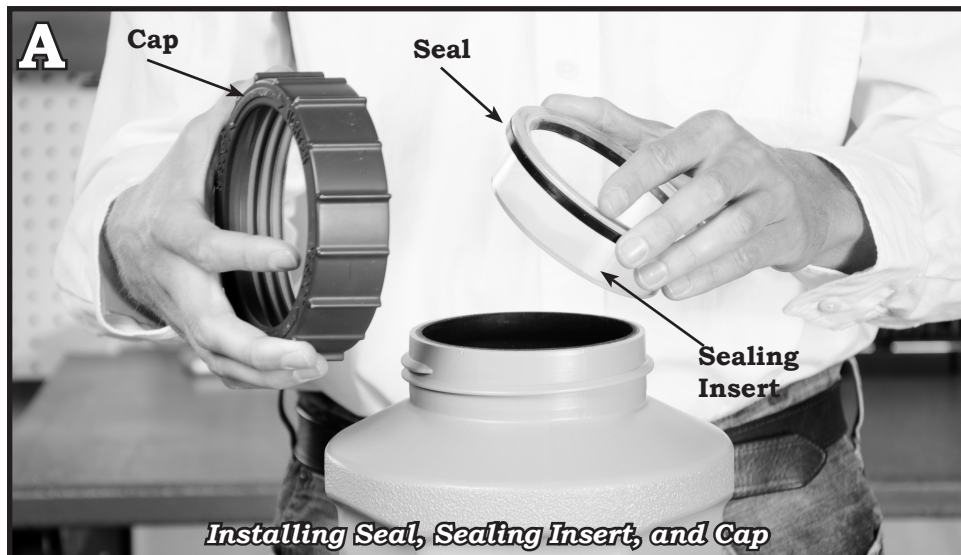

Tumbler Operation Instructions: (cont.)

2. Flip the drum over and add dirty brass to the drum.
3. Add 5lbs. of stainless steel media to the drum (*Only if you want the inside of the case and primer pocket to be extra clean*)
 - a. Additional stainless steel media can be purchased.
{Frankford Stainless Steel Media #909191}
 - b. For easy handling of stainless steel media, a Frankford Arsenal Media Magnet should be used.

**Frankford Arsenal
Media Magnet #909271
Sold Separately**



*Use the Frankford
Arsenal Media Magnet to
easily pickup and move
stainless steel media.*



Add 5lbs. of stainless steel media

4. Fill the drum with water to the bottom of the mouth opening.
(Total weight of the drum should not exceed 30lbs) (**Photo C**)
5. Add Frankford Arsenal Brass Cleaner to the water at 4x bottle caps of cleaner per 1x drum full of water. (**Photo C**)
{Frankford Brass Cleaner Part #878787}
 - a. To prevent damage to the Drum, Seals, Sealing Inserts, and Caps, only use Frankford Arsenal's Brass Cleaner.

NOTE: *This product comes with 1 sample packet of Frankford Brass Cleaning Solution. Add the entire packet to 1 load of brass.*



WARNING: Cleaning solutions can be corrosive.
Always wear protective gloves and safety glasses
when handling cleaning solutions.

Tumbler Operation Instructions: (cont.)



6. Install the second Seal, Clear Sealing Insert, and Cap, and ensure that both ends are tightened fully.

- a. Test the drum over a sink to ensure that both ends are fully sealed. Turn drum horizontally, shake, and rotate to ensure that there are no leaks.

NOTE: If drum leaks, tighten the caps further. If leak persists, remove the seal, sealing insert and cap and insure all the sealing surfaces are free of any debris.

NOTE: Drum may leak slightly when carrying drum by holding the Caps/Inserts.



Tumbler Operation Instructions: (cont.)

7. With the tumbler base timer turned off, and the drum fully sealed, place the drum on the rollers of the tumbler base.



WARNING: Keep hands, hair, and loose clothing away from the rollers. They may pinch, grab, or pull while in operation.

8. Once the drum is placed on the tumbler base, turn timer switch to the desired time setting.

- a. Based on brass caliber, amount of brass, and preference, different time settings can be used.
 - i. In general, for 0-500 pieces of brass, 1-2 hours is sufficient for effective cleaning.
 - ii. In general, for 500+ pieces of brass 2-3 hours is sufficient for effective cleaning
- b. If the brass is not as clean as desired, simply add more time to the timer.

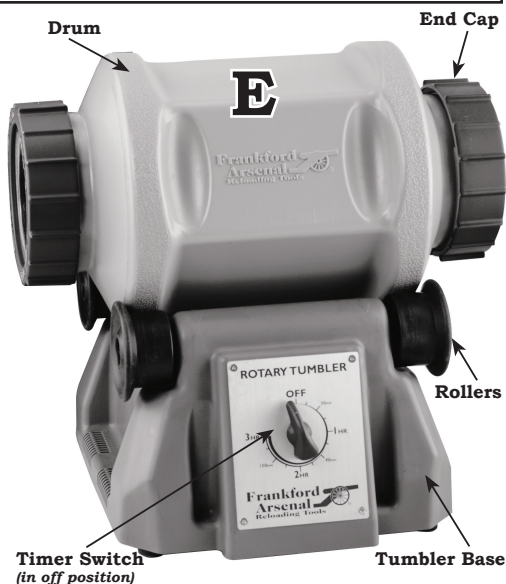

NOTE: If there is any water trapped in the threads, this water will leak out during the first few minutes.

TROUBLESHOOTING: If drum does not start rotating on its own power, turn off the timer switch and try the following:

- a. Brass and media settling to the bottom can cause the drum to be unbalanced. Rotate the drum by hand 10+ rotations then restart the timer.
- b. If the drum still does not move after step a. remove some of the weight from the drum and repeat step a.

9. After the time has elapsed, continue to the Post Tumbling Instructions.

Post Tumbling Instructions:

If tumbling **WITHOUT** Stainless Steel Media

1. Ensuring that the timer is in the off position and the drum is not rolling, take the drum off of the rollers and take the drum to a sink, bathtub, shower, or to a faucet/garden hose.
2. Remove the Threaded Cap, Seal, and Sealing Insert from one end of the drum, and replace with a Sifting Insert and the Threaded Cap.
3. Flip the drum over (*This will cause the dirty solution to start draining from the drum, so ensure that drum is in a bucket, over a drain, or outside where the solution can drain away*)



WARNING: Cleaning solutions can be corrosive. Always wear protective gloves and safety glasses when handling cleaning solutions.

4. Remove the Seal and Sealing Insert from the opposite end of the drum, and replace with the other Sifting Insert.
5. Rinse the brass by running water through one end of the drum and by shaking, rotating, and agitating the brass. Repeatedly flip the drum to the opposite end so that the brass is rinsed from both ends of the drum. (**Photo G**)

Post Tumbling Instructions: *(cont.)*



Twist and shake the drum to agitate the brass and rinse the solution out

TIP: *For optimal rinsing fill a bucket full of water, submerge one end of the drum in the water, and shake, rotate, and agitate the drum while submerging it in the water.*

6. After the brass is rinsed, remove the drum from the running water, sink or bucket full of water. Drain the majority of the water from the drum by shaking, rotating, and agitating the drum.
7. Proceed to the Drying Instructions.

If tumbling WITH Stainless Steel Media

1. Ensuring that the timer is in the off position and the drum is not rolling, take the drum off of the rollers and take the drum to a sink, bathtub, shower, or to a faucet/garden hose WITH a 5 gallon bucket.
2. Remove the Threaded Cap, Seal, and Sealing Insert from one end of the drum, and replace with a Sifting Insert and the Threaded Cap.
3. Flip the drum over into the bucket *(This will cause the dirty solution and Stainless Steel Media to start draining from the drum, so ensure that drum is in a bucket)* **(Photo H)**

Post Tumbling Instructions: (cont.)



4. Remove the Seal and Sealing Insert from the opposite end of the drum, and replace with the other Sifting Insert.
5. With the drum sitting in the bucket, fill the bucket 2/3 of the way with water.
6. Shake, rotate and agitate the drum while submerged in water, therefore forcing all of the media out of the drum, through the sifting insert, and into the bottom of the bucket.
 - a. Repeatedly flip the drum to the opposite end and shake, rotate, and agitate, to help flush all of the media out of the entire drum.

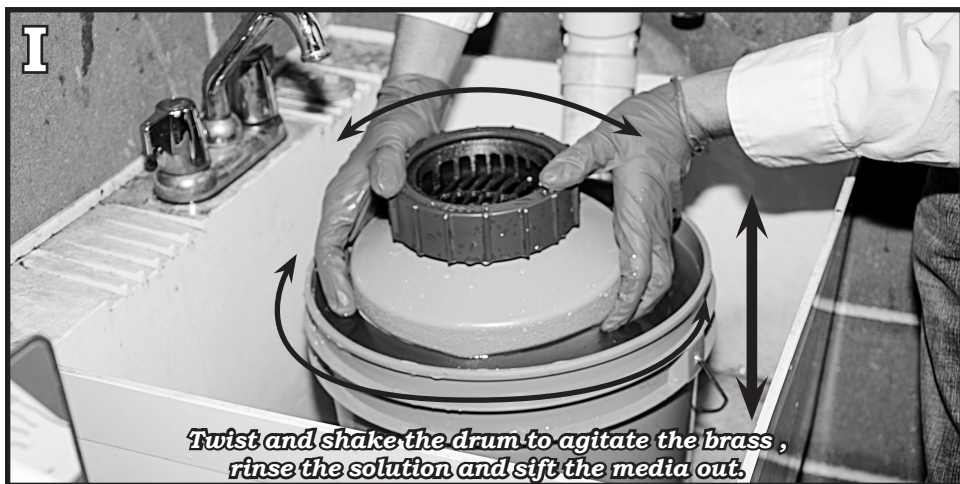

Post Tumbling Instructions: (cont.)

7. After the media is separated, pull the drum from the bucket full of water, and drain the majority of the water from the drum by shaking, rotating, and agitating the brass. **(Photo J)**

NOTE: Keep the drum over the bucket as some Stainless Steel Media may still be in the drum and will fall out into the bucket.

TIP: Be careful not to lose pins down the draining system. For ease of picking up loose pins, and for transferring pins from one location to another, a Frankford Arsenal Media Magnet should be used. Frankford Arsenal Media Magnet #909271

8. Proceed to the Drying Instructions.

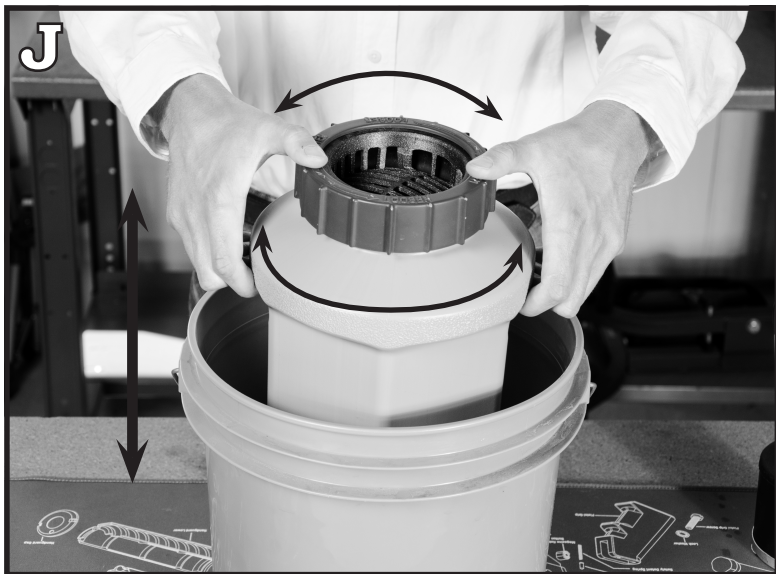

Twist and shake the drum over the bucket to remove any excess water.

TIP: Sift the media with the Frankford Arsenal Quick-N-EZ Rotary Media Separator Kit #507565. This is the fastest, easiest, and most optimal method for sorting the media from the brass.



Post Tumbling Instructions: *(cont.)*

Sifting with the Quick-N-EZ Rotary Separator

Take the Drum full of brass and media to a sink with the Quick-N-EZ Rotary Separator Kit and Bucket. Fill the bucket full of water until it is overflowing. This is part of the process to ensure maximum rinsing of the brass and separation of the media.

1. Open the Quick-N-EZ media separator bowl. Then remove the Cap, Seal, and Sealing Insert from one end of the drum. Pour the contents of the drum into the media separator bowl.
 - a. It is best to only fill the bowl about 2/3 full (roughly 400 cases)
2. Close the media separator bowl and rotate the bowl in both directions until all of the pins have sifted out of the brass to the bottom of the bucket.

Using the separator kit, dump brass into the bowl. For optimal performance only fill the bowl about 2/3 full of brass.



Rotate separator in bucket filled with water constantly changing rotation direction.

Post Tumbling Instructions: (cont.)

3. Once all the pins have been separated to the bottom of the bucket, pour out the water in the bucket until the separator bowl is no longer submerged in water. Then spin the bowl rapidly in both directions to drain out all of the water trapped in the brass.
4. Open separator bowl and empty separated brass into a clean bucket, bowl, or box.
5. Repeat steps 1-4 as many times as needed until all of the cases in the drum have been separated.

NOTE: *Be careful not to lose pins down the draining system. For ease of picking up loose pins, and for transferring pins from one location to another, a Frankford Arsenal Media Magnet should be used. {Frankford Media Magnet #909271}*

6. Proceed to the Drying Instructions.

Drying Instructions:

Once the media has been separated from the brass, the brass needs to be dried.

1. If the brass is excessively wet, or if the inside of the cases are holding water, put brass back into the tumbler drum and use the sifting caps to shake, rotate, and agitate the drum to drain out as much water as possible. **(Photo J)**

TIP: *Use the Quick-N-EZ Rotary Separator to drain out the water quickly and easily.*

2. Lay the brass on a towel and periodically roll the brass over to ensure complete uniform drying.

TIP: *Place a fan at one end of the towel to force airflow across the brass. Or use a blow dryer and dry the brass by waving the blow dryer over the brass. (Photo M)*

M



Lay brass out on a paper towel and place a fan next to it to dry the brass

General Notes:

1. Stainless Steel Pins should be stored cleaned and dried, and should be stored in a dry location.
 - a. If pins develop rust or corrosion, tumbling the pins in the brass cleaning solution and water will remove this rust and corrosion.
2. All tumbler parts should be stored, cleaned and dried, for optimal life.
3. Tumbler must be used on a flat hard surface .
 - a. Optimal tumbler location is on a concrete floor.
 - b. **Do not** use on carpet.
 - c. **Do not** use tumbler on a table, table top, work bench, or elevated surface as the tumbler may vibrate and walk off of an elevated surface.
4. Be careful not to set the drum on top of an elevated surface, as it may roll off the elevated surface.
5. All brass cases should be carefully checked, individually, to ensure that all pins have been removed from the inside of the case.
6. **Do not** leave brass soaking in the cleaning solution for prolonged periods, as the brass will begin to discolor.



WARNING: Keep hands, hair, and loose clothing away from the rollers. They may pinch, grab, or pull while in operation.

IMPORTANT SAFETY INSTRUCTIONS

SAVE THESE INSTRUCTIONS



WARNING: When using this electrical appliance, basic precautions should always be followed including the following:

1. Read all instructions before using this appliance.
2. To reduce the risk of injury, close supervision is necessary when this appliance is used near children.
3. Do not contact moving parts.
4. Only use attachments recommended or sold by Frankford Arsenal.
5. Do not use outdoors.
6. To disconnect, turn all controls to the OFF position, then remove the plug.
7. Do not unplug by pulling on the cord.
To unplug, grasp the plug, not the cord.
8. Do not operate this appliance with a damaged cord or plug, or if the unit malfunctions or is dropped or damaged in any manner. Return the unit for examination, repair, or electrical or mechanical adjustment.
9. To reduce the risk of electrical shock, do not put this appliance in water or other liquid.
10. Do not place or store this appliance where it can fall or be pulled into a tub or sink.
11. Remove plug from wall outlet when this appliance is not in use.
12. Never operate this appliance unattended.
13. Operate this appliance on a non-combustible surface away from all combustible materials including curtains, draperies, or walls.

For grounded appliance – Connect to a properly grounded outlet only. See Grounding Instructions.

This appliance must be grounded. In the event of malfunction or breakdown, grounding provides a path of least resistance for electric current to reduce the risk of electric shock. This appliance is equipped with a cord having an equipment-grounding conductor and a grounding plug. The plug must be plugged into an appropriate outlet that is properly installed and grounded in accordance with all local codes and ordinances.

DANGER - Improper connection of the equipment-grounding conductor can result in a risk of electric shock. The conductor with insulation having an outer surface that is green with or without yellow stripes is the equipment-grounding conductor. If repair or replacement of the cord or plug is necessary, do not connect the equipment-grounding conductor to a live terminal. Check with a qualified electrician or serviceman if the grounding instructions are not completely understood, or if in doubt as to whether the appliance is properly grounded. Do not modify the plug provided with the appliance - if it will not fit the outlet, have a proper outlet installed by a qualified electrician.

This appliance is for use on a nominal 120 V circuit, and has a grounding plug that looks like the plug illustrated in sketch “A”. A temporary adapter, which looks like the adapter in sketches “B” and “C”, may be used to connect this plug to a 2-pole receptacle as shown in sketch “B” if a properly grounded outlet is not available. The temporary adapter should be used only until a properly grounded outlet can be installed by a qualified electrician. The green colored rigid ear, lug, and the like, extending from the adapter must be connected to a permanent ground such as properly grounded outlet cover box. Whenever the adapter is used, it must be held in place by the metal screw.

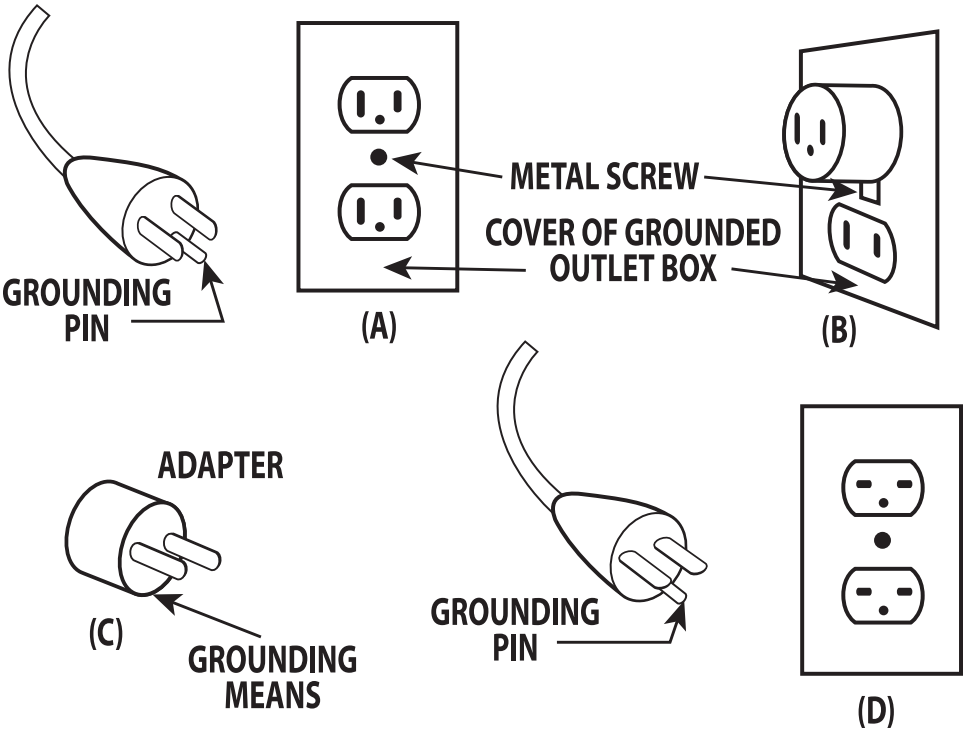

Platinum
SERIES

**Frankford
Arsenal** 
Reloading Tools

ROTARY TUMBLER



Product #909544



2501 LeMone Industrial Blvd. / Columbia, MO 65201
573-445-9200 / Email: sales@battenfeldtechnologies.com